

Site Vicinity

INSET A LEGEND

Estimated Extent of Petroleum Hydrocarbon Exceedances in Soil

Inset A Note:
Soil analytical data collected from depths of 15 feet or less were compared to the Alaska DEC 18 AAC 75 Method Two soil cleanup criteria for over-40-inch rainfall.

**SWMU 23, HEART LAKE DRUM DISPOSAL AREA
LEGAL DESCRIPTION PER G.P.S.**

That portion of Adak Naval Air Station, Adak Island, Alaska, described as follows:
Commencing at U.S. Navy control point A-5 (which is a 37MM shell case stamped A-5 EL 1944 set in the top of a 6-inch square concrete monument) which is North 06 ° 59'46" West 2,325.06 feet from U.S. Navy control point BEE (which is a 37MM shell case stamped BEE EL 1945 set in the top of a 6-inch square concrete monument);
Thence South 76 ° 19'53" West 4,819.56 feet to the POINT OF BEGINNING;
Thence South 16 ° 59'54" West 129.68 feet;
Thence South 25 ° 05'46" West 215.45 feet;
Thence South 70 ° 15'50" West 234.65 feet;
Thence North 80 ° 44'01" West 286.66 feet;
Thence North 08 ° 44'56" East 305.38 feet;
Thence North 12 ° 06'42" West 247.41 feet;
Thence North 80 ° 52'35" East 392.52 feet;
Thence South 44 ° 41'04" East 356.92 feet to the POINT OF BEGINNING. Containing 7.19 acres more or less.

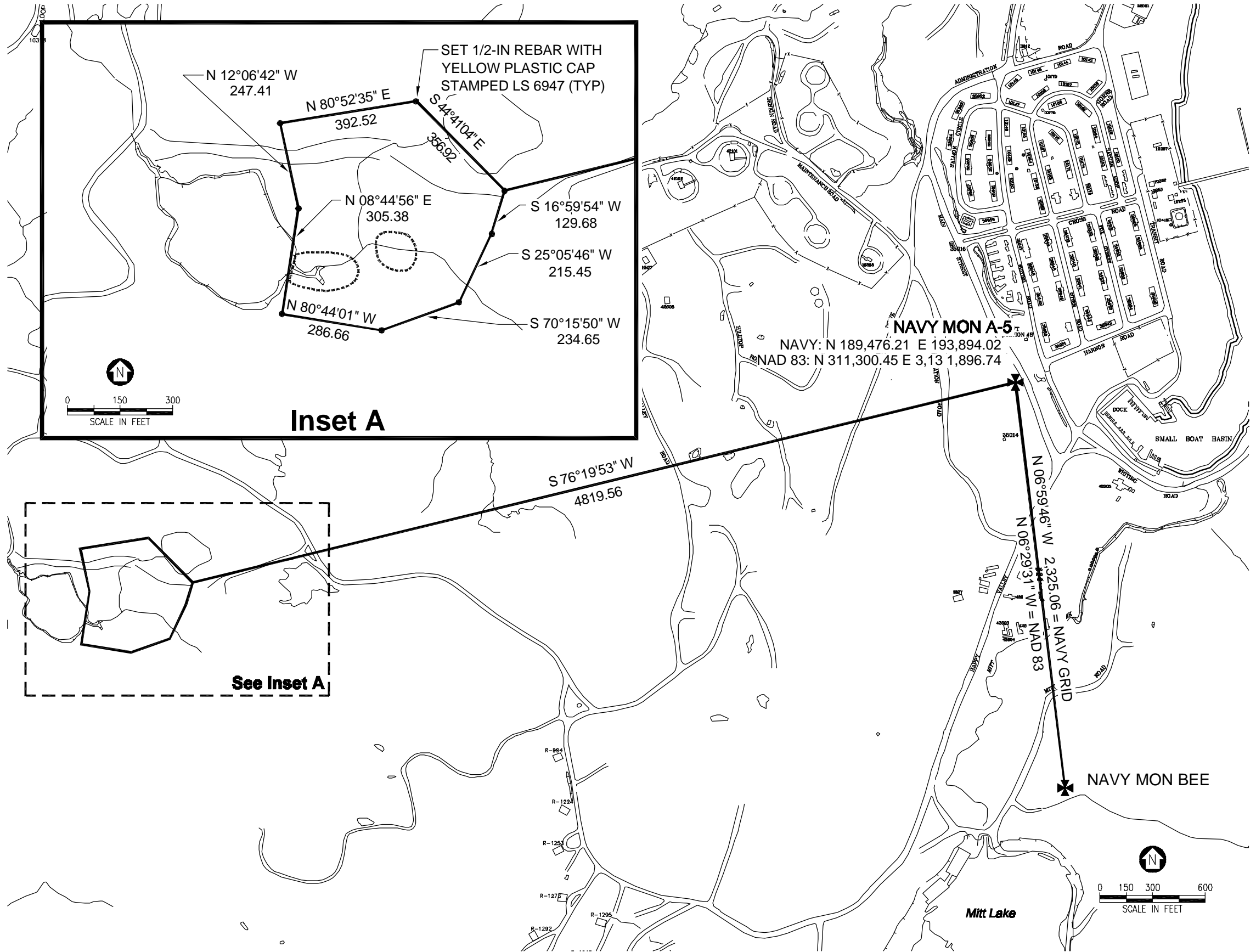

Inset A

See Inset A

FILENAME: T:\ADAK\IDIQ\Sub-Tasks\DO 11\Survey-Exceed\NEW SURVEY 10-01\NEW\SWMU 23.dwg
EDIT DATE: 11/05/01 AT: 14:01

U.S. NAVY	Delivery Order 011 Adak Island, AK	Scale as Shown	SWMU 23, Heart Lake Drum Disposal Area
------------------	---------------------------------------	----------------	---